

American Chestnut — Natural Countryside Collection

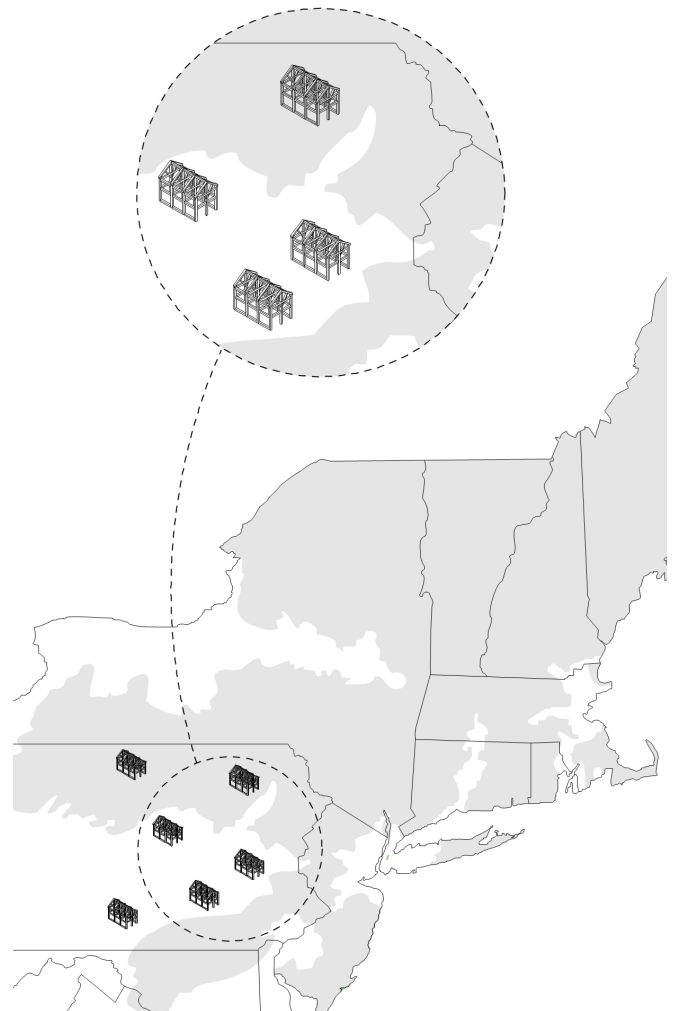

Product Information

This treasured species was used extensively for the construction of agricultural structures until the 20th century. Today, old-growth American Chestnut is only available through reclamation. Our warm Natural finish accentuates the coffee tones, rippling grain, and trademark wormholes characteristic of this refined hardwood.

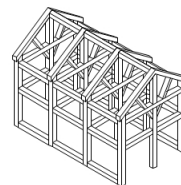

Source

Reclaimed hardwoods from pre-industrial timber-frame structures throughout the Northeast.

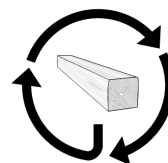

Impact

Historic material re-use and local manufacturing support a circular economy and reduces a building project's carbon footprint.

American Chestnut — Natural

Countryside Collection

Solid Wood Elements

SELECT YOUR SPECS

Format	Profile	Thickness	Element Size & Shape	Element Cutout
Multi-Piece Top	Hand Eased	1"	Custom Width & Length	Lighting
Stair Tread & Riser	Roundover	1-1/4"	Custom Shape	Hardware
	Bevel	1-1/2"		Custom Carving
	Bullnose	2"		
	Knife Edge			

Common Spec*

Multi-Piece Top | Hand Eased Profile | 1-1/2" Thickness

*include sketch to indicate overall dimensions, shape, and cutout locations

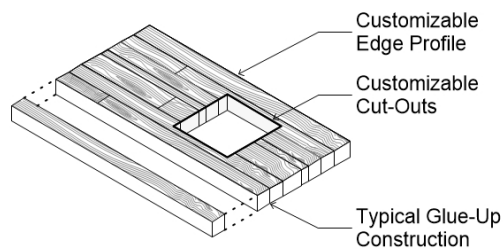

MULTI-PIECE TOP

Made of edge-glued solid wood pieces to create dynamic solid surfaces, these tops are versatile and customizable.

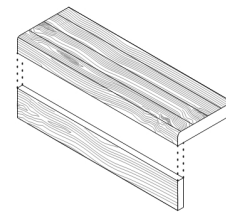

STAIR TREAD & RISER

Our single-piece or glue-up solid wood stair components are durable and customizable.

SELECT YOUR PROFILE



HAND EASED



ROUND OVER



BEVEL



BULLNOSE



KNIFE EDGE



FINISH

We apply green finishes by hand to bring out the natural beauty of wood with added durability and easy maintenance.

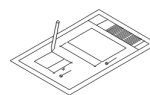

SHOP DRAWING

We provide detailed shop drawings and installation guides customized to each project.

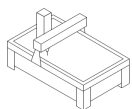

CNC MILLING

Our solid wood elements are customized with precision using digital fabrication tools and techniques.



SUPPORT

We are part of your project team, working collaboratively before and after the order arrives on site to ensure smooth project delivery.