

# Heritage Oak — Neutral

## Countryside Collection

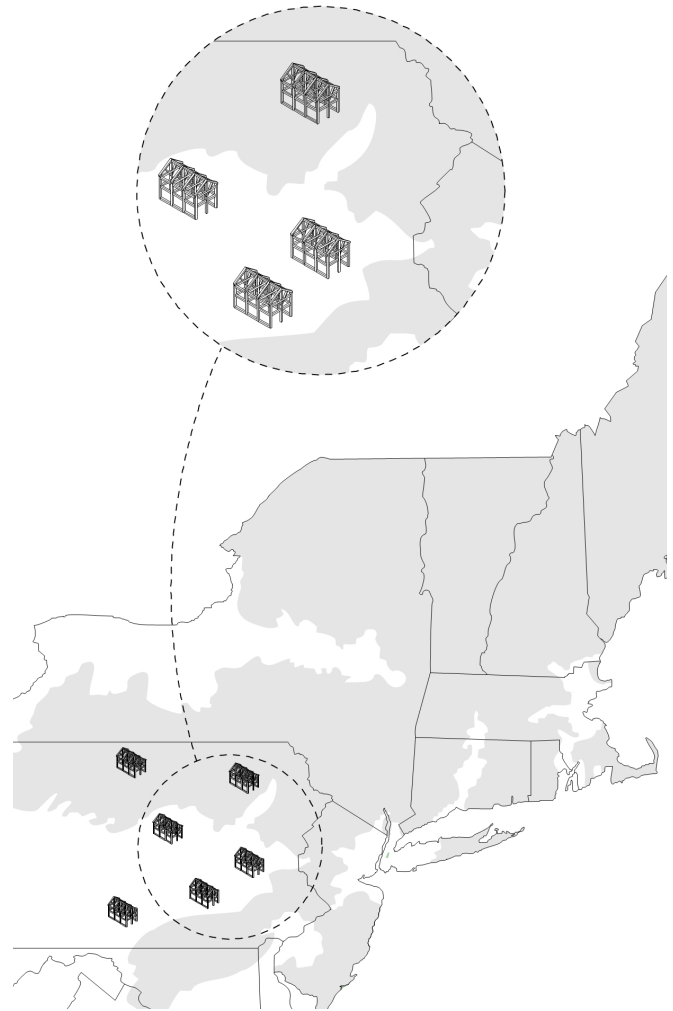
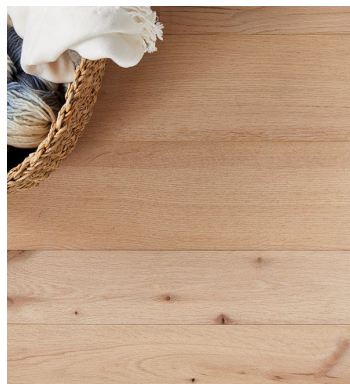

### Product Information

Our Neutral finish tames the warm red and brown tones characteristic of Red Oak, foregrounding its rich grain, along with character marks inherited from past use. With its trusted sturdiness and distinct look, this hardwood can prove its worth on any project.

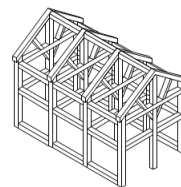

### Source

Reclaimed hardwoods from pre-industrial timber-frame structures throughout the Northeast.

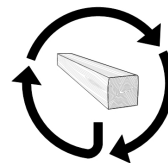

### Impact

Historic material re-use and local manufacturing support a circular economy and reduces a building project's carbon footprint.

# Heritage Oak — Neutral

## Countryside Collection

## Slatted Panels

### SELECT YOUR SPECS

Format	Slat Profile	Slat Thickness	Slat Width	Slat Spacing	Panel Size
Partition Panel	Square Edge	3/4"	1"	3/4"	2' x 4'
Hanging Panel	Bullnose	1"	2"	1"	2' x 6'
	Double Bevel	1-1/4"	3"	1-1/4"	4' x 4'
		1-1/2"	4"	1-1/2"	4' x 8'
				2"	2' x 10'

### Common Spec\*

Hanging Panel | Square Edge Profile | 3/4" Slat Thickness | 2" Slat Width | 1" Slat Spacing | 2' x 6' Panel Size

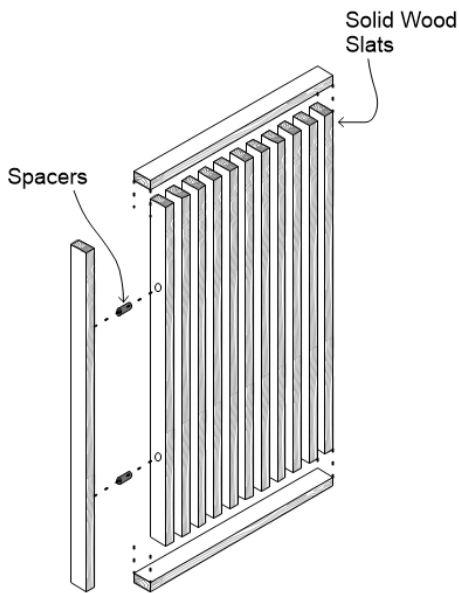

PARTITION SLAT PANEL

Shop-fabricated panel assemblies of linear solid wood slats for versatile partition applications.

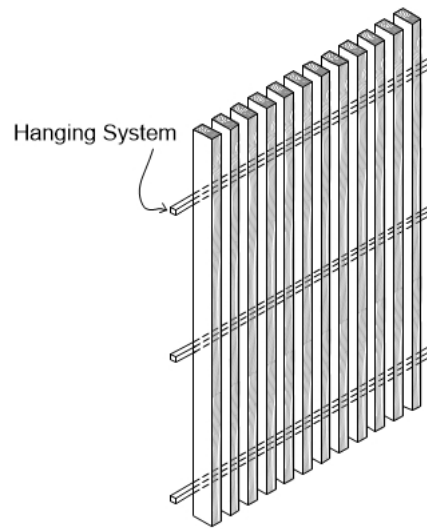

HANGING SLAT PANEL

Shop-fabricated panel assemblies of linear solid wood slats for hung wall and ceiling applications.



### FINISH

We apply green finishes by hand to bring out the natural beauty of wood with added durability and easy maintenance.

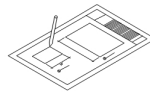

### SHOP DRAWING

We provide detailed shop drawings and installation guides customized to each project.

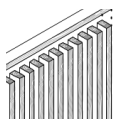

### LAYOUT

Our linear wood systems are customized for dimension, spacing, and profile to fit the unique conditions of each project.



### SUPPORT

We are part of your project team, working collaboratively before and after the order arrives on site to ensure smooth project delivery.